

TOOL HOLDER SYSTEM

ACCESSORIES



ห้างหุ้นส่วนจำกัด เลิศไพบุณย์ สตีล Lert Piboon Steel Ltd., Part.

● BT PULL STUDS



MODEL NO.	TYPE θ	d_3	L	l_1	T	SW
SYIC - 17801	BT30 - 45°	12.5	43	23	M12	13
SYIC - 17803	BT40 - 45°	17	60	35	M16	19
SYIC - 17805	BT50 - 45°	25	85	45	M24	30
SYIC - 17806	BT30 - 60°	12.5	43	23	M12	13
SYIC - 17808	BT40 - 60°	17	60	35	M16	19
SYIC - 17810	BT50 - 60°	25	85	45	M24	30
SYIC - 17812	BT30 - 90°	12.5	43	23	M12	13
SYIC - 17814	BT40 - 90°	17	60	35	M16	19
SYIC - 17816	BT50 - 90°	25	85	45	M24	30

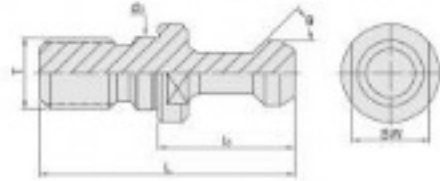

● CAT PULL STUDS COOLANT TYPE



INCHES

MODEL NO.	TYPE	L	l_1	θ	SW	T-UNC
SYIC - 21003 - C	CAT40 - ANSI - C	1.5	0.64	45°	0.75	5/8" - 11
SYIC - 21005 - C	CAT50 - ANSI - C	2.3	1		1.25	1" - 8
SYIC - 21003 - 45C	CAT40 - Coolant - I	2.25	1.266	45°	0.748	5/8" - 11
SYIC - 21003 - 60C	CAT40 - Coolant - II			60°		
SYIC - 21003 - 90C	CAT40 - Coolant - III			90°		
SYIC - 21005 - 45C	CAT50 - Coolant - I	3.346	1.772	45°	1.181	1" - 8
SYIC - 21005 - 60C	CAT50 - Coolant - II			60°		
SYIC - 21005 - 90C	CAT50 - Coolant - III			90°		

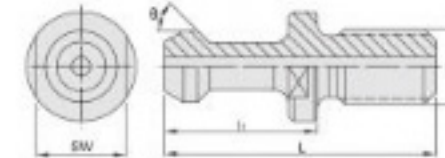

● BT PULL STUDS COOLANT TYPE



MODEL NO.	TYPE θ	d_3	L	l_1	T	SW
SYIC - 17817	BT30 - 45°	12.5	43	23	M12	13
SYIC - 17818	BT40 - 45°	17	60	35	M16	19
SYIC - 17820	BT40 - 60°					
SYIC - 17822	BT40 - 90°	25	85	45	M24	30
SYIC - 17824	BT50 - 45°					
SYIC - 17826	BT50 - 60°					
SYIC - 17828	BT50 - 90°					



● DAT PULL STUDS COOLANT TYPE



MODEL NO.	TYPE	d_3	d_4	L	l_1	T
SYIC - 49003	DAT40 - A	17	7	54	26	M16
SYIC - 49005	DAT50 - A	25	11.5	74	34	M24

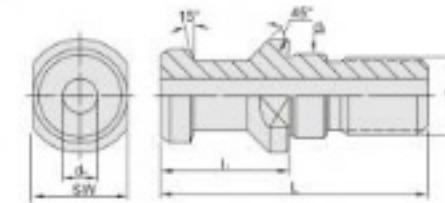

● CAT PULL STUDS



INCHES

MODEL NO.	TYPE	L	l_1	θ	SW	T-UNC
SYIC - 21003	CAT40 - ANSI	1.5	0.64	45°	0.75	5/8" - 11
SYIC - 21005	CAT50 - ANSI	2.3	1		1.25	1" - 8
SYIC - 21003 - 45	CAT40 - MAS - I	2.25	1.266	60°	0.748	5/8" - 11
SYIC - 21003 - 60	CAT40 - MAS - II			90°		
SYIC - 21003 - 90	CAT40 - MAS - III			90°		
SYIC - 21005 - 45	CAT50 - MAS - I	3.346	1.772	45°	0.181	1" - 8
SYIC - 21005 - 60	CAT50 - MAS - II			60°		
SYIC - 21005 - 90	CAT50 - MAS - III			90°		

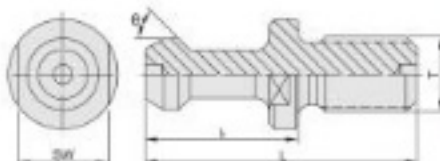

● DAT PULL STUDS



MODEL NO.	TYPE	d_3	d_4	L	l_1	SW	T
SYIC - 49013	DAT40 - B	17	7	54	26	19	M16
SYIC - 49015	DAT50 - B	25	11.5	74	34	30	M24

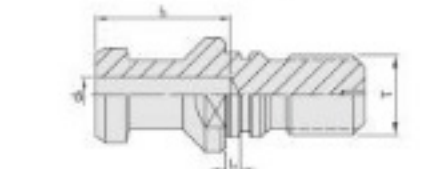



ห้างหุ้นส่วนจำกัด เลิศไพบุณ สตีล Lert Piboon Steel Ltd., Part.

● STEEL SEALED COLLET

ER



MODEL NO.	TYPE	WATER PRESSURE	SIZE RANGE
SYIC - 04543	ER16	70 kgf/cm ²	φ3 - φ10
SYIC - 04544	ER20		φ3 - φ13
SYIC - 04545	ER25		φ3 - φ16
SYIC - 04546	ER32		φ3 - φ20
SYIC - 04547	ER40		φ3 - φ26



● ER COLLET

ER



MODEL NO.	TYPE	WATER PRESSURE	SIZE RANGE
SYIC - 04208	ER8	70 kgf/cm ²	φ1 - φ5
SYIC - 04211	ER11		φ1 - φ7
SYIC - 04216	ER16		φ1 - φ10
SYIC - 04220	ER20		φ2 - φ13
SYIC - 04225	ER25		φ2 - φ16
SYIC - 04232	ER32		φ3 - φ20
SYIC - 04240	ER40		φ3 - φ26
SYIC - 04250	ER50		φ6 - φ34

● ER COLLET

ER



MODEL NO.	TYPE	WATER PRESSURE	SIZE RANGE
SYIC - 04311	ER11	70 kgf/cm ²	φ1 - φ7
SYIC - 04316	ER16		φ1 - φ10
SYIC - 04320	ER20		φ2 - φ13
SYIC - 04325	ER25		φ2 - φ16
SYIC - 04332	ER32		φ3 - φ20
SYIC - 04340	ER40		φ3 - φ26

● ER SEALED COLLET

ER



MODEL NO.	TYPE	WATER PRESSURE	SIZE RANGE
SYIC - 08316	ER16	70 kgf/cm ²	φ3 - φ10
SYIC - 08320	ER20		φ3 - φ13
SYIC - 08325	ER25		φ3 - φ16
SYIC - 08332	ER32		φ3 - φ20
SYIC - 08340	ER40		φ3 - φ26



● ER COOLANT COLLET(FID TYPE)

ER-FID



MODEL NO.	TYPE	WATER PRESSURE	SIZE RANGE
202.126.16	ER16 - FID	21 kgf/cm ²	φ3 - φ7
202.126.20	ER20 - FID		φ3 - φ9
202.126.25	ER25 - FID		φ3 - φ14
202.126.32	ER32 - FID		φ3 - φ20
202.126.40	ER40 - FID		φ3 - φ26



● ER COOLANT COLLET(FOD TYPE)

ER-FOD



MODEL NO.	TYPE	WATER PRESSURE	SIZE RANGE
202.127.16	ER16 - FOD	21 kgf/cm ²	φ3 - φ7
202.127.20	ER20 - FOD		φ4 - φ9
202.127.25	ER25 - FOD		φ3 - φ14
202.127.32	ER32 - FOD		φ3 - φ20
202.127.40	ER40 - FOD		φ4 - φ26
202.127.50	ER50 - FOD		φ6 - φ34



● ER TCO RIGID TAP SEALED COLLET

ER



MODEL NO.	TYPE	WATER PRESSURE	CAPACITY
254.16	ER - TCO16	70 kgf/cm ²	M5 - M10
254.20	ER - TCO20		M5 - M17
254.25	ER - TCO25		M5 - M22
254.32	ER - TCO32		M5 - M27
254.40	ER - TCO40		



● ER FLOATING TAP COLLET

ER



MODEL NO.	TYPE	PRESSURE	CAPACITY
SYIC - 05916	FT16	70 kgf/cm ²	M5 - M10
SYIC - 05920	FT20		M5 - M17
SYIC - 05925	FT25		M5 - M22
SYIC - 05932	FT32		M5 - M27
SYIC - 05940	FT40		



● POWER GOOD ER CLAMPING NUT

ER

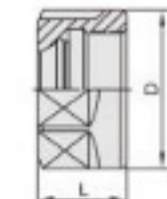

MODEL NO.	TYPE	D	L
SYIC - 04501P	ER11 - A	19	11.3
SYIC - 04502P	ER16 - A	28	17.5
SYIC - 04503P	ER20 - A	34	19
SYIC - 04506P	ER16 - UM/RD	31.7	18
SYIC - 04507P	ER20 - UM/RD	35	19.5
SYIC - 04508P	ER25 - UM/RD	42	20
SYIC - 04509P	ER32 - UM/RD	50	22.5
SYIC - 04510P	ER40 - UM/RD	63	25.5
SYIC - 04511P	ER50 - UM/RD	78	35.5
SYIC - 04524P	ER11 - M	16	11.3
SYIC - 04525P	ER16 - M	22	18
SYIC - 04526P	ER20 - M	28	19

● HIGH SPEED POWER GOOD NUT

ER

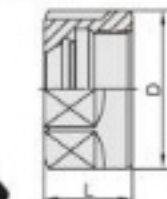

MODEL NO.	TYPE	D	L
SYIC - 08652P	ER11A - HS	19	11.3
SYIC - 08654P	ER16A - HS	18	17.5
SYIC - 08656P	ER20A - HS	34	19
SYIC - 08655P	ER16 - HS	32	18
SYIC - 08657P	ER20 - HS	35	19.5
SYIC - 08658P	ER25 - HS	42	20
SYIC - 08660P	ER32 - HS	50	22.5
SYIC - 08662P	ER40 - HS	63	25.5

● ER NON WIND RESISTANCE NUT

ER



MODEL NO.	TYPE	D	L
206.130.16	ER16	30	17.5
206.130.20	ER20	34	19
206.130.25	ER25	42	20
206.130.32	ER32	50	22.5



ห้างหุ้นส่วนจำกัด เลิศไพบุณย์ สตีล Lert Piboon Steel Ltd., Part.

● PNER COLLET PNER



MODEL NO.	TYPE	WATER PRESSURE	SIZE RANGE
SYIC - 04216-PN	PNER16	70 kgf/cm ²	φ 3 ~ φ 10
SYIC - 04220-PN	PNER20		φ 3 ~ φ 13
SYIC - 04225-PN	PNER25		φ 3 ~ φ 16
SYIC - 04232-PN	PNER32		φ 3 ~ φ 20
SYIC - 04240-PN	PNER40		φ 6 ~ φ 26

● PNER GOOD PNER CLAMPING NUT PNER



MODEL NO.	TYPE	D	L
SYIC - 04506-PN	PNER16	30	23
SYIC - 04507-PN	PNER20	32	24
SYIC - 04508-PN	PNER25	40	24
SYIC - 04509-PN	PNER32	50	27
SYIC - 04510-PN	PNER40	63	30

● ER TORQUE WRENCH ER



MODEL NO.	TYPE	D	L
286.129.11	ER11 W-RDQ	φ 43	119.85
286.129.16	ER16 W-RDQ	φ 55	169.85
286.129.20	ER20 W-RDQ / SKS13 W-RDQ	φ 59	172.10
286.129.25	ER25 W-RDQ	φ 67	175.85
286.129.32	ER32 W-RDQ	φ 75	180.00

● ER TORQUE WRENCH ER



MODEL NO.	TYPE	D	L
SYIC - 285.30	ER16, PNER16	30	195
SYIC - 285.32	PNER20	32	
SYIC - 285.34	ER20	34	235
SYIC - 285.40	PNER25	40	
SYIC - 285.50	ER32, PNER32	50	

● ER SPANNER (WRENCH) ER



MODEL NO.	TYPE	L	A
SYIC - 04615	ER25 UM/RD	206	37.0
SYIC - 04616	ER32 UM/RD	253	46.5
SYIC - 04617	ER40 UM/RD	289	58.0
SYIC - 04618	ER50 UM/RD	351	74.0

MODEL NO.	TYPE	L	A
SYIC - 04608	ER11 - A	120	17.0
SYIC - 04609	ER16 - A	140	25.0
SYIC - 04610	ER20 - A	160	30.0
SYIC - 04621	ER11 - M	95	11.5
SYIC - 04622	ER16 - M	117	15.0
SYIC - 04623	ER20 - M	129	19.5

● NUT ADAPTERS FOR EXCHANGEABLE TORQUE WRENCH



MODEL NO.	TYPE	D	L
SYIC - 04582	ER16	53	79
SYIC - 04584	ER20	60	75
SYIC - 04586	ER25	65	72
SYIC - 04588	ER32	75	
SYIC - 04590	ER40	90	85

MODEL NO.	TYPE	D	L
287.128.11	ER11 W-TDQ	43	73.35
287.128.16	ER16 W-TDQ	55	95.35
287.128.20	ER20 W-TDQ / SKS13 -TDQ	59	89.60
287.128.25	ER25 W-TDQ	67	97.35
287.128.32	ER32 W-TDQ	75	105.5

● PARTS FOR COMBI SHELL END MILL ARBOR



SYIC - 42860 NUT

MODEL NO.	TYPE	d ₁	l ₁	l ₂
SYIC - 42861	CONU - 16	20	16	6
SYIC - 42863	CONU - 22	28	18	7
SYIC - 42865	CONU - 27	35	22	8
SYIC - 42867	CONU - 32	42	26	9
SYIC - 42869	CONU - 40	52	30	10
SYIC - 42871	CONU - 50	63	36	12

SYIC - 42880 SPANNER

MODEL NO.	TYPE	d ₁	l ₁
SYIC - 42881	COSP - 16	22	180
SYIC - 42883	COSP - 22	28	200
SYIC - 42885	COSP - 27	35	225
SYIC - 42887	COSP - 32	42	250
SYIC - 42889	COSP - 40	52	280
SYIC - 42891	COSP - 50	63	315

● SPIGOT INTERCHANGEABLE DIGITAL TORQUE WRENCH



MODEL NO.	TYPE	RANGE	
SYIC - 04575 - 135	DG - 135	10 - 135 N.m	7.4 - 99.6 ft/lbs
SYIC - 04575 - 200	DG - 200	20 - 200 N.m	14.8 - 147 ft/lbs
SYIC - 04575 - 340	DG - 340	34 - 340 N.m	25 - 250.9 ft/lbs
SYIC - 283.DG252	DG - 252	10 - 135 N.m	7.4 - 99.6 ft/lbs
SYIC - 283.DG253	DG - 253	20 - 200 N.m	14.8 - 147 ft/lbs
SYIC - 283.DG254	DG - 254	34 - 340 N.m	25 - 250.9 ft/lbs
SYIC - 283.DG264	DG - 264	10 - 135 N.m	7.4 - 99.6 ft/lbs
SYIC - 283.DG265	DG - 265	20 - 200 N.m	14.8 - 147 ft/lbs
SYIC - 283.DG266	DG - 266	34 - 340 N.m	25 - 250.9 ft/lbs
SYIC - 283.DG271	DG - 271	10 - 135 N.m	7.4 - 99.6 ft/lbs
SYIC - 283.DG272	DG - 272	20 - 200 N.m	14.8 - 147 ft/lbs
SYIC - 283.DG273	DG - 273	34 - 340 N.m	25 - 250.9 ft/lbs



ห้างหุ้นส่วนจำกัด เลิศไพบุณย สตีล Lert Piboon Steel Ltd., Part.

● STRAIGHT SHANK COLLET

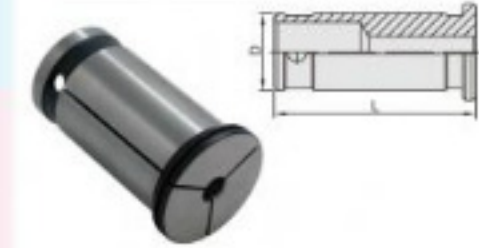

MODEL NO.	TYPE	SIZE RANGE	D	L
SYIC - 84116	SSC12	φ 3 ~ φ 8	12	44.5
SYIC - 84123	SSC16	φ 3 ~ φ 12	16	50.0
SYIC - 84120	SSC20	φ 3 ~ φ 16	20	52.5
SYIC - 84121	SSC25	φ 3 ~ φ 20	25	60.0
SYIC - 84122	SSC32	φ 3 ~ φ 25	32	64.6
SYIC - 84124	SSC42	φ 3 ~ φ 32	42	75.0
SYIC - 84126	SSC3/4"	φ 1/8" ~ φ 5/8"	3/4"	52.5
SYIC - 84128	SSC1"	φ 1/8" ~ φ 3/4"	1"	60.0
SYIC - 84127	SSC1-1/4"	φ 1/8" ~ φ 1"	1-1/4"	64.6

● STRAIGHT SHANK SEALED COLLET



MODEL NO.	TYPE	SIZE RANGE	D	L
SYIC - 19461	SSC12 - C	φ 3 ~ φ 8	12	47.1
SYIC - 19462	SSC20 - C	φ 3 ~ φ 16	20	52.9
SYIC - 19464	SSC25 - C	φ 3 ~ φ 20	25	52.5
SYIC - 19466	SSC32 - C	φ 3 ~ φ 25	32	66.0
SYIC - 19468	SSC42 - C	φ 3 ~ φ 32	42	75.0
SYIC - 19472	SSC1/2" - C	φ 1/8" ~ φ 3/8"	1/2"	46.8
SYIC - 19474	SSC3/4" - C	φ 1/8" ~ φ 5/8"	3/4"	52.9
SYIC - 19476	SSC1" - C	φ 1/8" ~ φ 3/4"	1"	52.5
SYIC - 19478	SSC1-1/4" - C	φ 1/8" ~ φ 1"	1-1/4"	66.0

● SPANNER



MODEL NO.	TYPE	L
SYIC - 04645	MLD12 / MLD1/2"	200
SYIC - 18324-20	MLD16 / MLD5/8"	220
SYIC - 84192G	MLD20 / MLD3/4"	260
SYIC - 84194	MLD25 / MLD1"	250
SYIC - 84193G	MLD32 / MLD1-1/4"	272

● MLD SEALED CAP w/o coolant hole MLD



MODEL NO.	TYPE	RANGE
SYIC - 19490G	MLD12 / MLD1/2"	φ 3 ~ φ 8 , φ 1/8" ~ φ 3/8"
SYIC - 19491G	MLD16 / MLD5/8"	φ 3 ~ φ 12 , φ 1/8" ~ φ 1/2"
SYIC - 19496G	MLD20 / MLD3/4"	φ 3 ~ φ 16 , φ 1/8" ~ φ 5/8"
SYIC - 19497G	MLD25 / MLD1"	φ 3 ~ φ 20 , φ 1/8" ~ φ 3/4"
SYIC - 19498G	MLD32 / MLD1-1/4"	φ 3 ~ φ 26 , φ 1/8" ~ φ 1"
SYIC - 19495G	MLD42	φ 3 ~ φ 32

● SLC COLLET SLC



MODEL NO.	TYPE	SIZE RANGE	L
SYIC - 18851	SLC - 6	φ 3 ~ φ 6	36
SYIC - 18852	SLC - 12	φ 3 ~ φ 12	57
SYIC - 18853	SLC - 20	φ 3 ~ φ 20	70
SYIC - 18855	SLC - 25	φ 3 ~ φ 25	80

● T SPANNER T

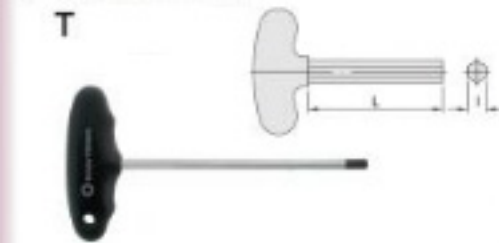

MODEL NO.	TYPE	L	I
B11 - A - 11T20X200 - B	T20 - 200	200	T20
B11 - A - 11T40X100 - B	T40 - 100	100	T40
B11 - A - 11T40X200 - B	T40 - 200	200	T40
B11 - A - 10T5X150 - B	T5 - 150	150	5
B11 - A - 10T5X200 - B	T5 - 200	200	5
B11 - A - 10T6X150 - B	T6 - 150	150	6
B11 - A - 10T6X200 - B	T6 - 200	200	6
B11 - A - 10T8X200 - B	T8 - 200	200	8

● SKS COLLET SKS



MODEL NO.	TYPE	SIZE RANGE	L
SYIC - 18302	SKS6	φ 1 ~ φ 6	25.7
SYIC - 18304	SKS10	φ 2 ~ φ 10	32.0
SYIC - 18304 - E	SKS - 10E	φ 3 ~ φ 10	32.0
SYIC - 18305	SKS13	φ 3 ~ φ 13	39.1
SYIC - 18305 - E	SKS - 13E	φ 3 ~ φ 13	39.1
SYIC - 18306	SKS16	φ 3 ~ φ 16	46.0
SYIC - 18306 - E	SKS - 16E	φ 4 ~ φ 16	46.0
SYIC - 18308	SKS20	φ 3 ~ φ 20	54.3
SYIC - 18308 - E	SKS - 20E	φ 3 ~ φ 20	54.3
SYIC - 18310	SKS25	φ 3 ~ φ 25.4	58.2

● SKS SEALED COLLET SKS



MODEL NO.	TYPE	SIZE RANGE	L
SYIC - 18304C	SKS - 10C	φ 3 ~ φ 10	32.0
SYIC - 18305C	SKS - 13C	φ 3 ~ φ 13	39.1
SYIC - 18306C	SKS - 16C	φ 3 ~ φ 16	46.0
SYIC - 18308C	SKS - 20C	φ 3 ~ φ 20	54.3
SYIC - 18310C	SKS - 25C	φ 3 ~ φ 25.4	58.2

● SKS CLAMPING NUT SKS

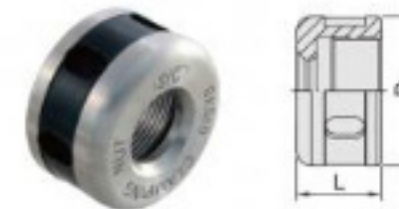

MODEL NO.	TYPE	D	L
SYIC - 18312	SKS6	18.0	15.0
SYIC - 18314	SKS10	30.0	17.0
SYIC - 18315-13	SKS13	35.0	21.0
SYIC - 18316	SKS16	40.0	24.5
SYIC - 18318	SKS20	48.5	24.0
SYIC - 18320	SKS25	55.0	30.5

● SKS COOLANT NUT SKS



MODEL NO.	TYPE	D	L
203.658.10	SKS10 - CO	30.0	22.8
203.658.13	SKS13 - CO	35.0	26.5
203.658.16	SKS16 - CO	40.0	32.2
203.658.20	SKS20 - CO	48.5	29.5
203.658.25	SKS25 - CO	55.0	40.0

● SKS NON WIND RESISTANCE NUT SKS



MODEL NO.	TYPE	D	L
206.668.06	SKS-6	18	15.0
206.668.10	SKS-10	30	17.0
206.668.13	SKS-13	34	21.0
206.668.16	SKS-16	40	25.4
206.668.20	SKS-20	48	24.0
206.668.25	SKS-25	55	30.5

● SK3 NON WIND RESISTANCE NUT SK3



MODEL NO.	TYPE	D	L
SYIC - 206.763.06	SK306	18	21
SYIC - 206.763.10	SK310	27	24
SYIC - 206.763.13	SK313	34	28
SYIC - 206.763.16	SK316	40	31



ห้างหุ้นส่วนจำกัด เลิศไพบุณ สตีล Lert Piboon Steel Ltd., Part.

● SKS SPANNER (WRENCH) SKS



MODEL NO.	TYPE	L
SYIC - 18322	SKS6	120
SYIC - 18323	SKS10	220
SYIC - 18323-13	SKS13	
SYIC - 18324	SKS16	
SYIC - 18324-20	SKS20	
SYIC - 18325	SKS25	
		250

● SKS TORQUE WRENCH SKS



MODEL NO.	TYPE	D	L
286.667.06	SKS6 W-RDQ	43	169.85
286.129.20	SKS13 W-RDQ / ER20 W-RDQ	58	172.85
286.667.16	SKS16 W-RDQ	65	174.85
286.667.20	SKS20 W-RDQ	75	197.35
286.667.25	SKS25 W-RDQ	80	182.35

● SKS TORQUE WRENCH SKS



MODEL NO.	TYPE	D	L
SYIC - 285.18	SKS6, SK306	18	195
SYIC - 285.27	SK310	27	
SYIC - 285.30	SKS10	30	
SYIC - 285.34	SKS13, SK313	34	235
SYIC - 285.40	SKS16, SK316	40	
SYIC - 285.48	SKS20	48	

● NUT ADAPTERS FOR EXCHANGEABLE TORQUE WRENCH



MODEL NO.	TYPE	D	L
SYIC - 04597-6	SKS6	36	68
SYIC - 04597-10	SKS10	29.6	76
SYIC - 04597-13	SKS13	29.6	79
SYIC - 04597-16	SKS16	37.8	100
SYIC - 04597-20	SKS20	40	99
SYIC - 04597-25	SKS25	41	102

MODEL NO.	TYPE	D	L
287.128.20	SKS13 W-TDQ / ER20 W-TDQ	35	21
287.666.16	SKS16 W-TDQ	65	95.35
287.666.20	SKS20 W-TDQ	48.5	24
287.666.25	SKS25 W-TDQ	80	110.35

● COOLANT PRESET SCREW

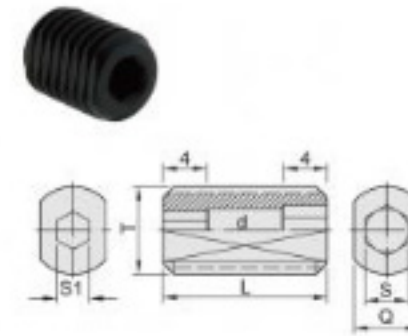

MODER NO.	T	L	d	S	S1	Q
SYIC - 19192	M5 x 0.8P	15	2	2	2	3
SYIC - 19193	M6 x 1.0P		3	2.5	2.5	4
SYIC - 19194	M8 x 1.25P		4	4	3	6
SYIC - 19195	M10 x 1.5P		5	5	4	8
SYIC - 19196	M12 x 1.75P		6	6	5	10
SYIC - 19197	M16 x 2.0P	25	6	8	6	14
SYIC - 19198	M20 x 2.0P			10	8	18

● COOLANT PRESET SCREW

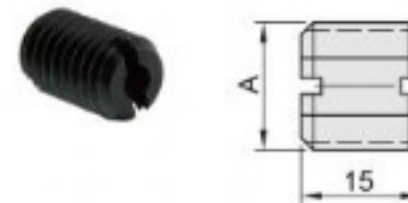

MODER NO.	TYPE
SYIC - 16081C	M6 x 1.0P - 15
SYIC - 16082C	M8 x 1.25P - 15
SYIC - 16083C	M10 x 1.5P - 15
SYIC - 16085C	M12 x 1.75P - 15
SYIC - 16089C	M16 x 2.0P - 15
SYIC - 16091C	M20 x 2.0P - 15
SYIC - 16093C	M24 x 2.0P - 15

● SET SCREW MLD

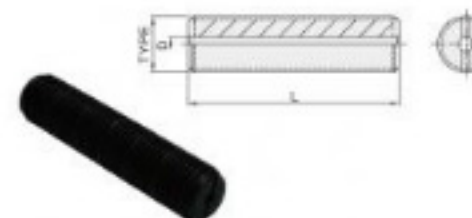

MODEL NO.	TYPE	L	D	SUITABLE RANGE
SYIC - 15946 - 1	M12 x 1.75P	40	φ4	BT30 / DAT30
SYIC - 15947 - 1	M16 x 2.0P	60		BT40 / DAT40
SYIC - 15947 - 2	5/8" - 11UNC			CAT40
SYIC - 15948 - 1	M24 x 3.0P			BT50 / DAT50
SYIC - 15948 - 2	1" - 8UNC			CAT50

● SHELL MILL SCREW

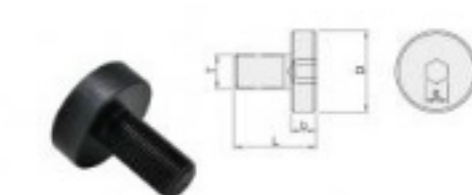

MODEL NO.	TYPE	D	L
SYIC - WF - 0.5	1/2"	5/8" = 15.875	21.336
SYIC - WF - 0.75	3/4"	7/8" = 22.225	34.798
SYIC - WF - 1	1"	1-3/16" = 30.1625	
SYIC - WF - 1.25	1-1/4"	1-1/2" = 38.1	44.45
SYIC - WF - 1.5	1-1/2"	1-7/8" = 47.625	
SYIC - WF - 2	2"	2-1/2" = 63.5	50.8
SYIC - WF - 2.5	2-1/2"	3-1/8" = 79.375	57.15

● PRESET SCREW



MODER NO.	TYPE	Fig.
SYIC - 16081	M6 x 1.0P - 15	1
SYIC - 16082	M8 x 1.25P - 15	
SYIC - 16082 - 25	M8 x 1.25P - 25	2
SYIC - 16083	M10 x 1.5P - 15	1
SYIC - 16085	M12 x 1.75P - 15	
SYIC - 16087	M12 x 1.75P - 25	2
SYIC - 16089	M16 x 2.0P - 15	
SYIC - 16091	M20 x 2.0P - 15	1
SYIC - 16093	M24 x 2.0P - 15	